

付図1 縄文時代晩期土器全体図① (1/50)

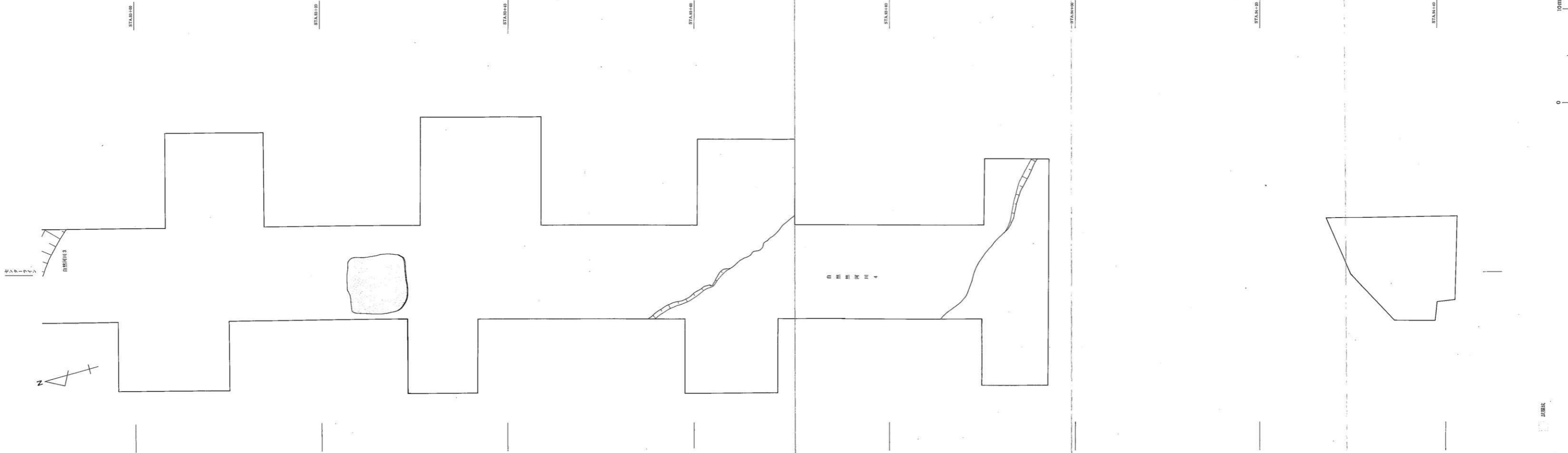

付図2 縄文時代晚期全体図② (1/500)

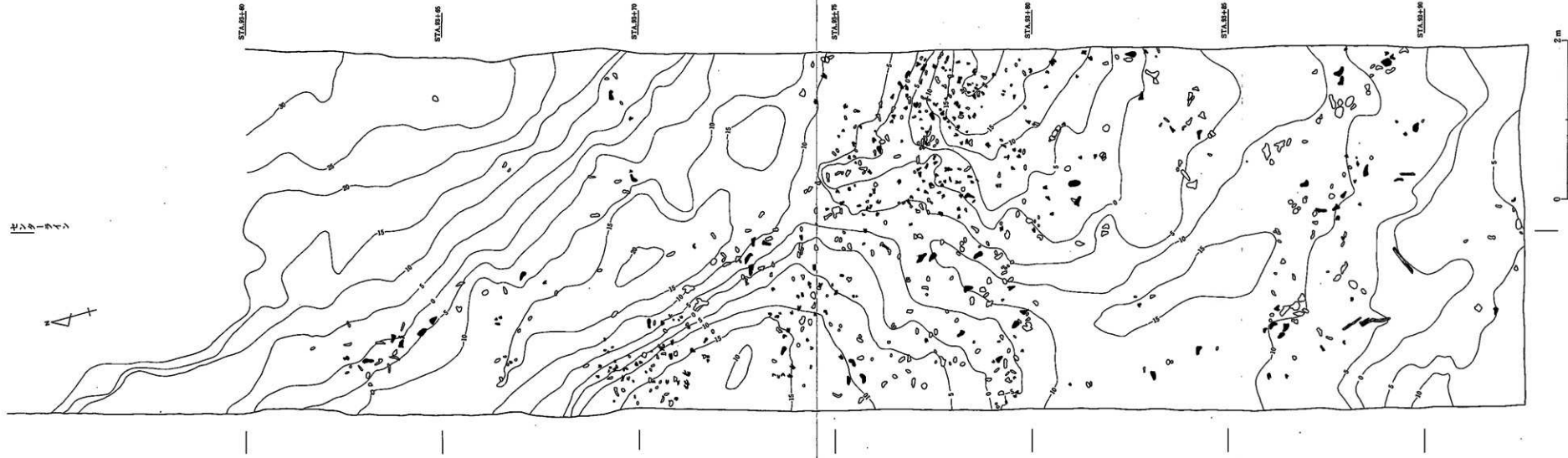

付図3 縄文時代晩期Cトレンチ自然河川4底 人間、鹿足跡 (%)
 5cmコンターライン

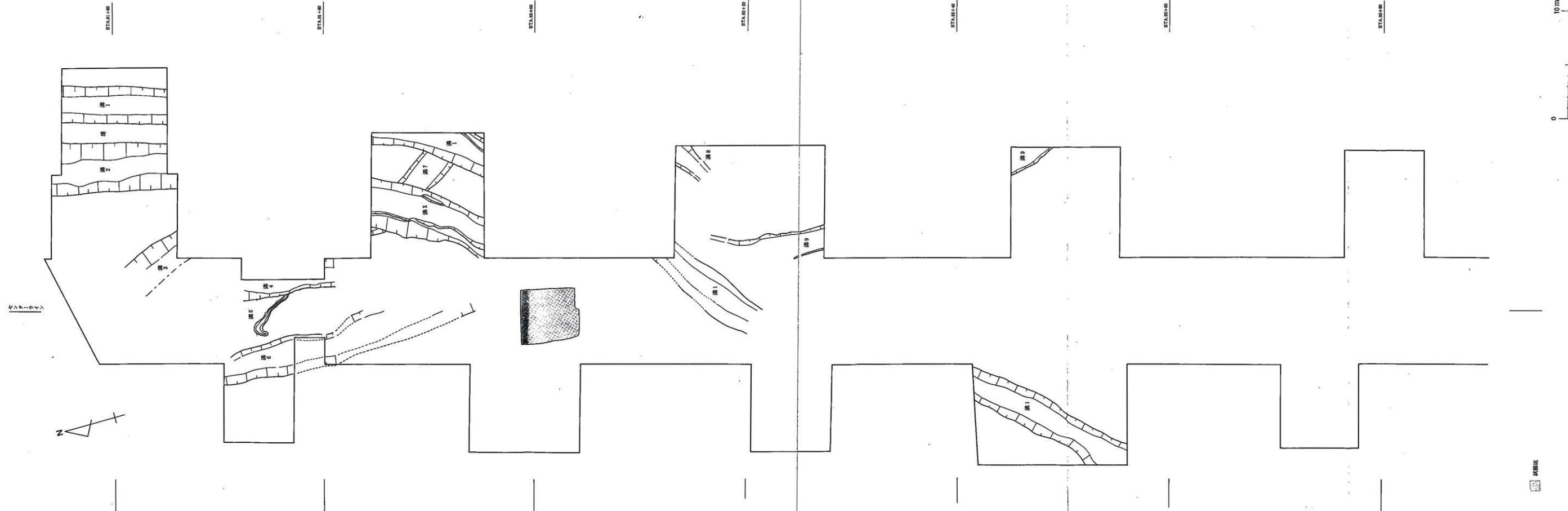

付図4 弥生時代前期全体図①(1/500)

4.88-0.22

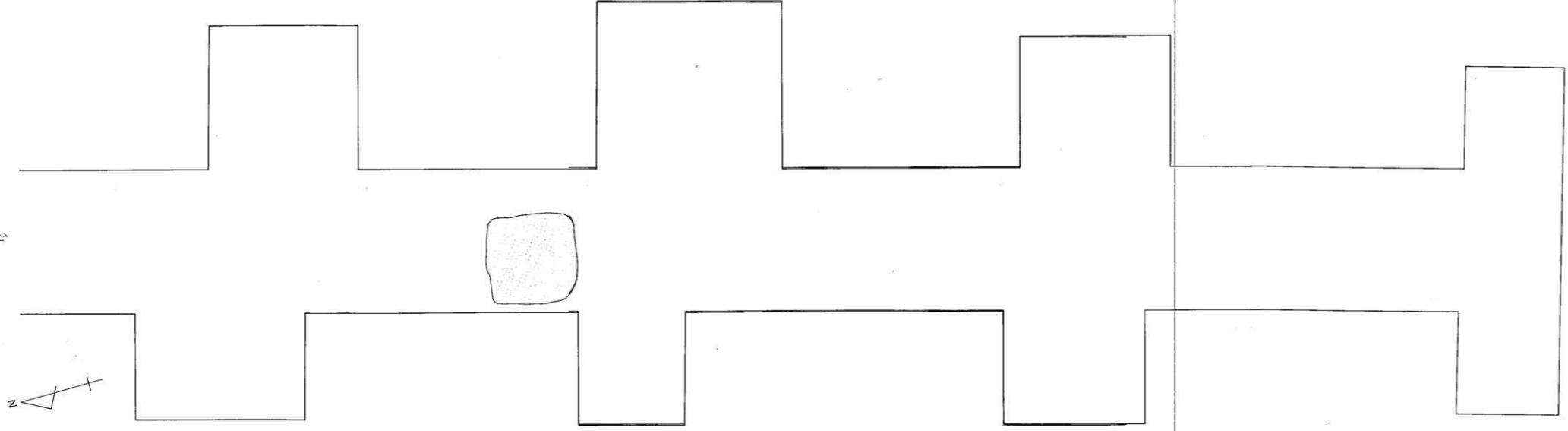

STATION

STATION

STATION

STATION

STATION

STATION

STATION

STATION

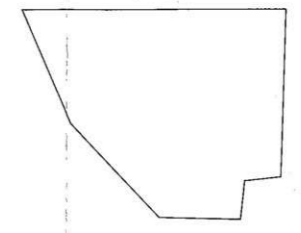

10m



付圖7 弥生中期I全体図② (1/500)

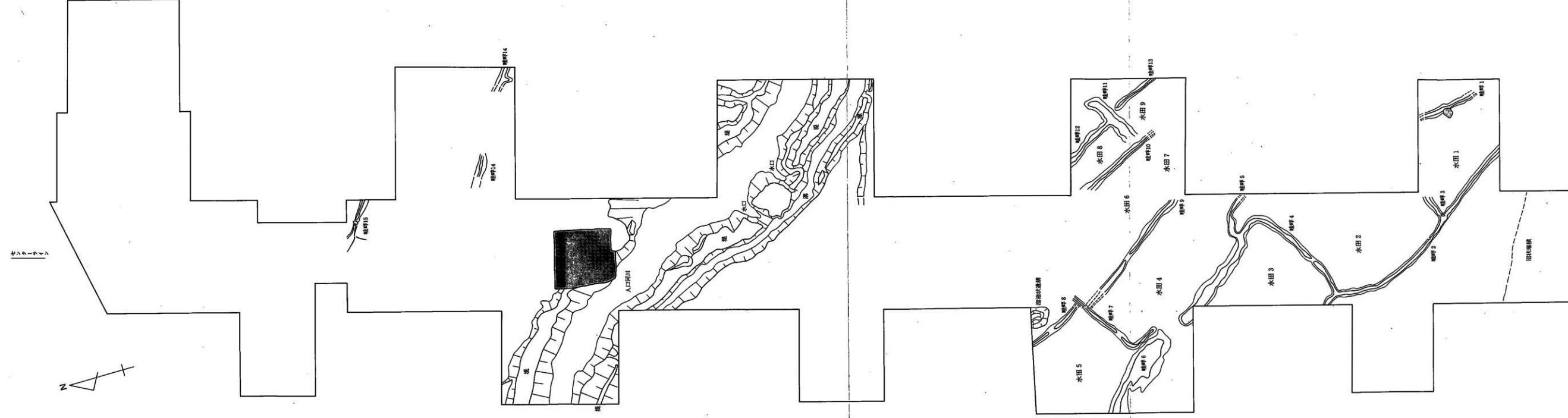

採掘地、遺構

付図 6 弥生時代中期 I 全体図① (1/500)

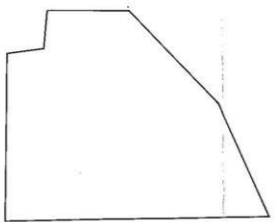
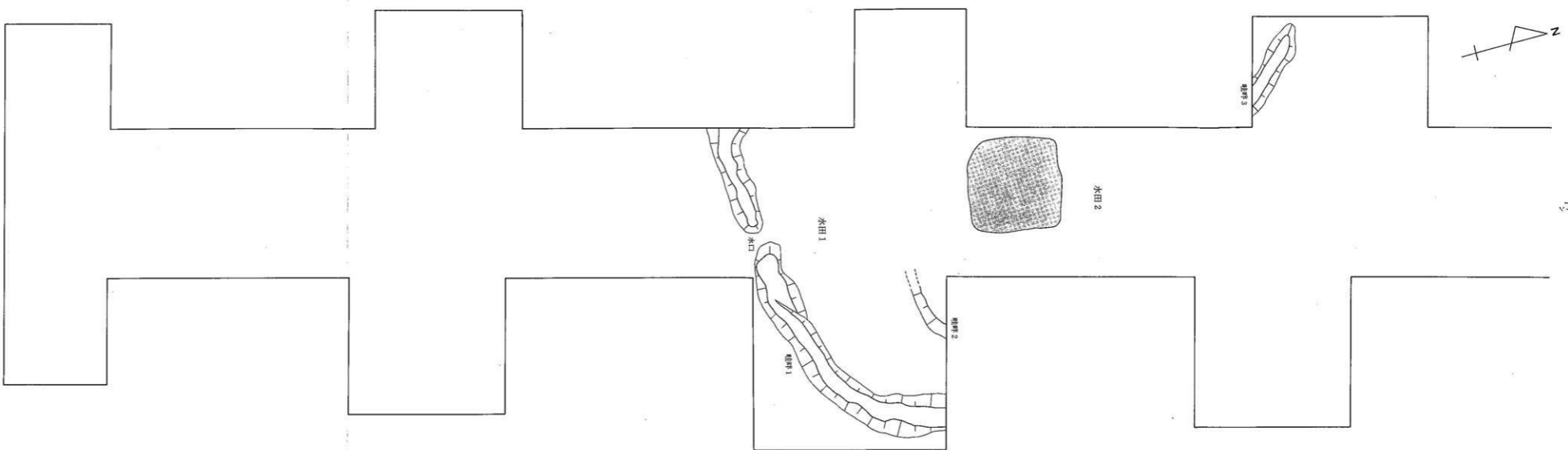

付図12 弥生時代後期 I 全体図② (5m)

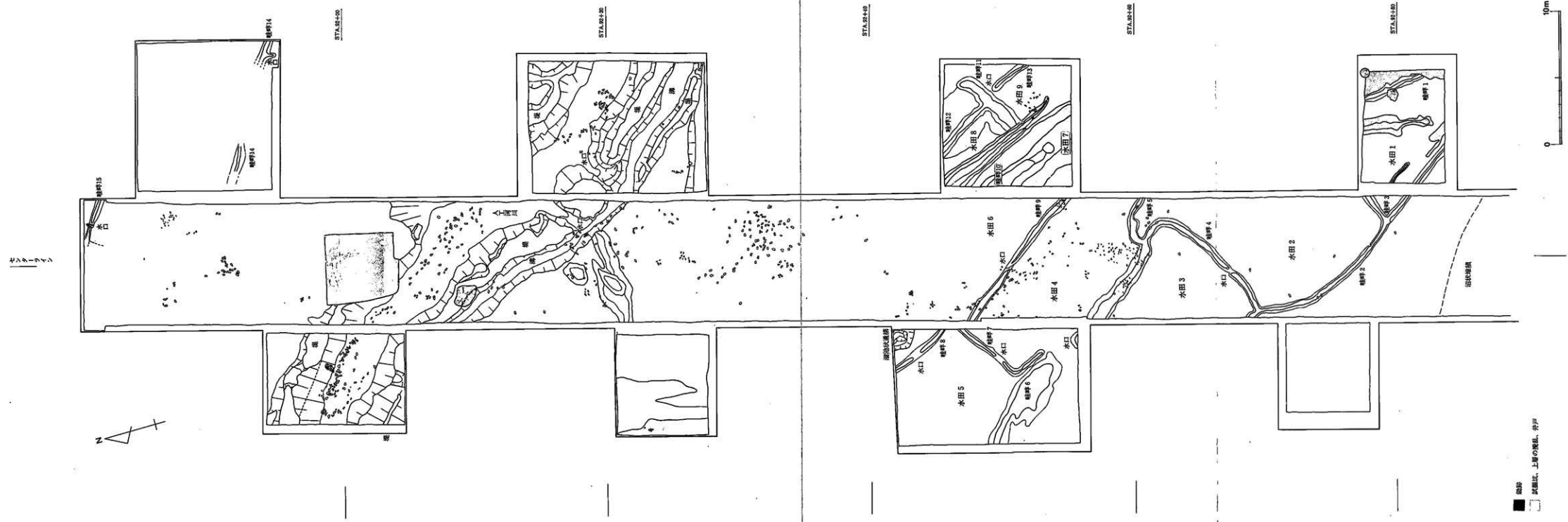

付図8 弥生時代中期Ⅰ水田面 (1/500)

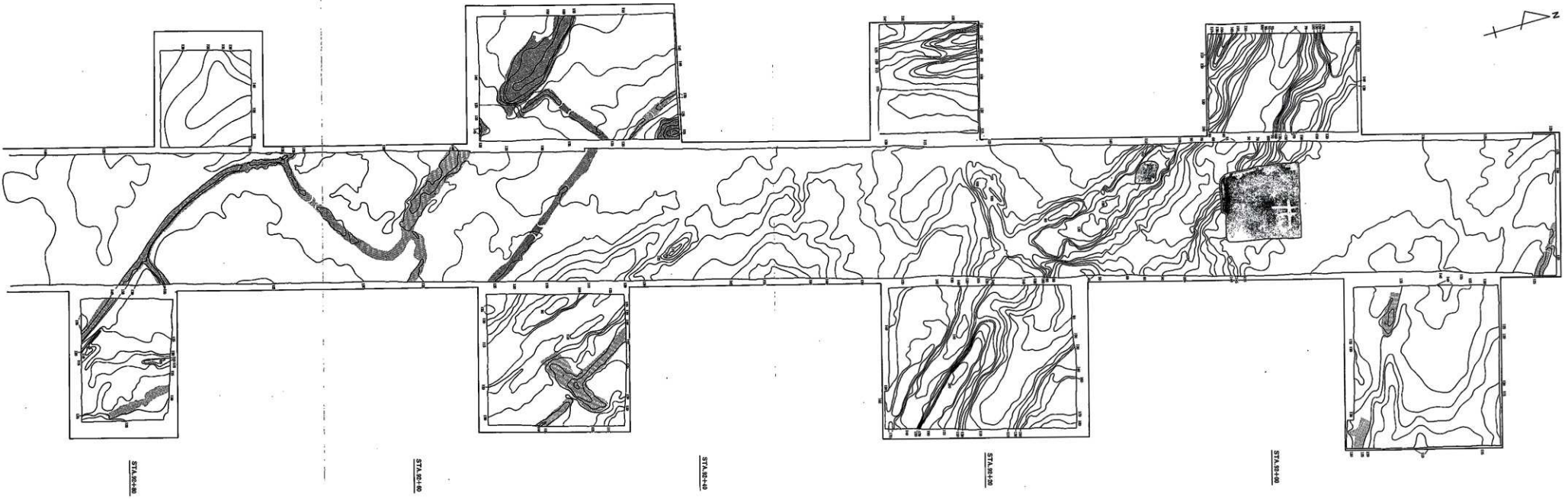

付図 9 弥生時代中期 I 水田面 (No.)

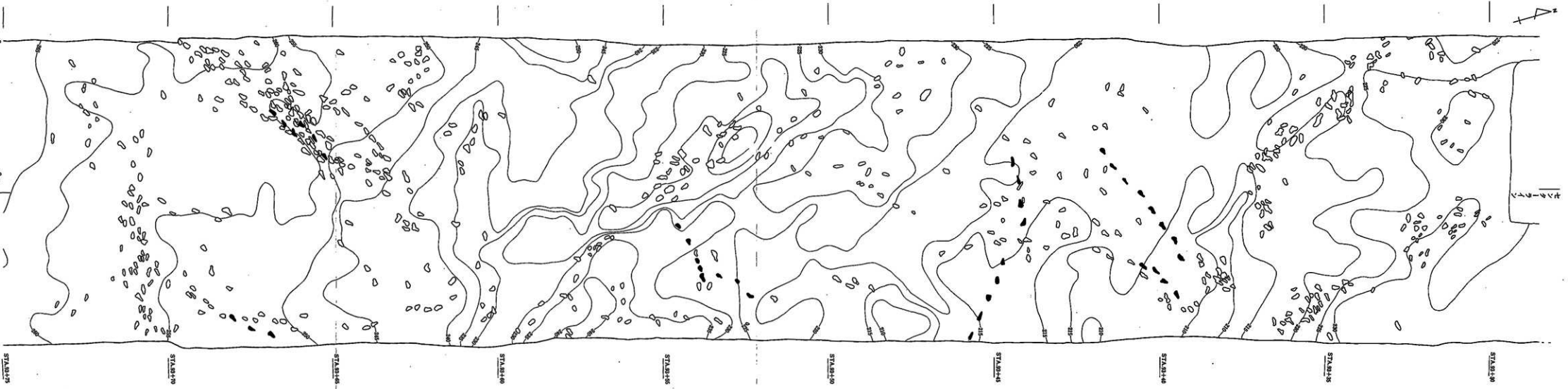

付図10 弥生時代中期ⅡB・Cトレンチ 人間足跡 (約
5cmコンテラ-947)

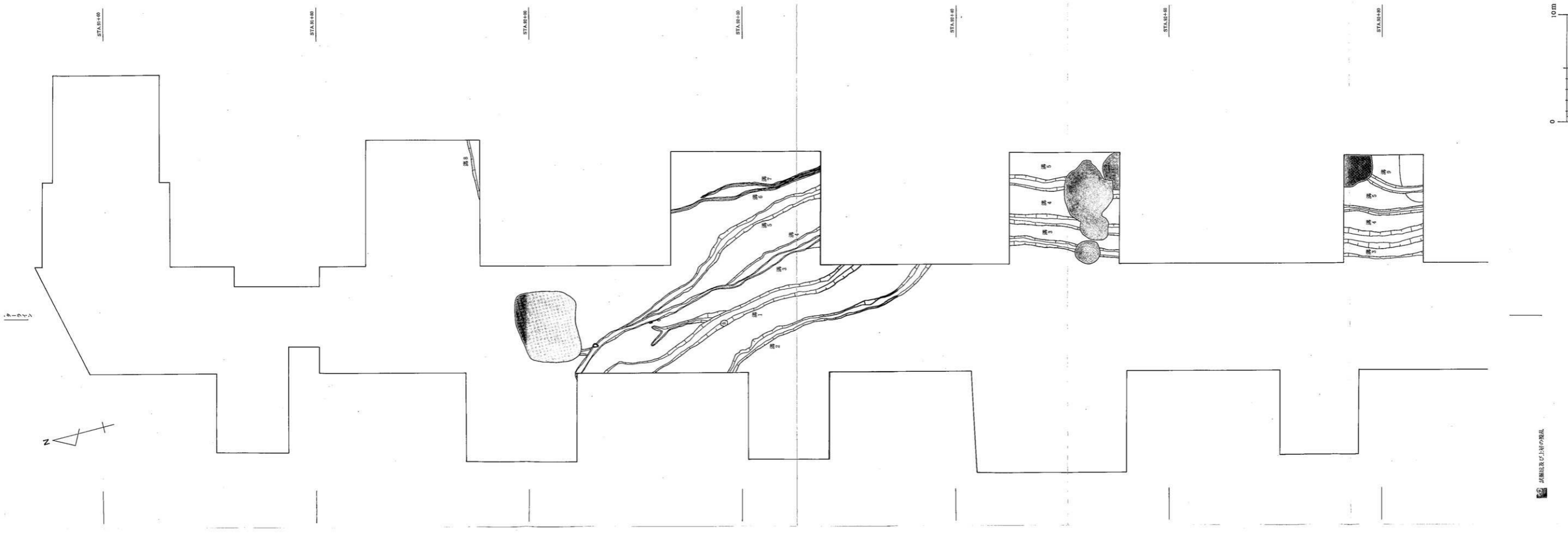

付図13 第三紀後期Ⅱ全体図① (5m)

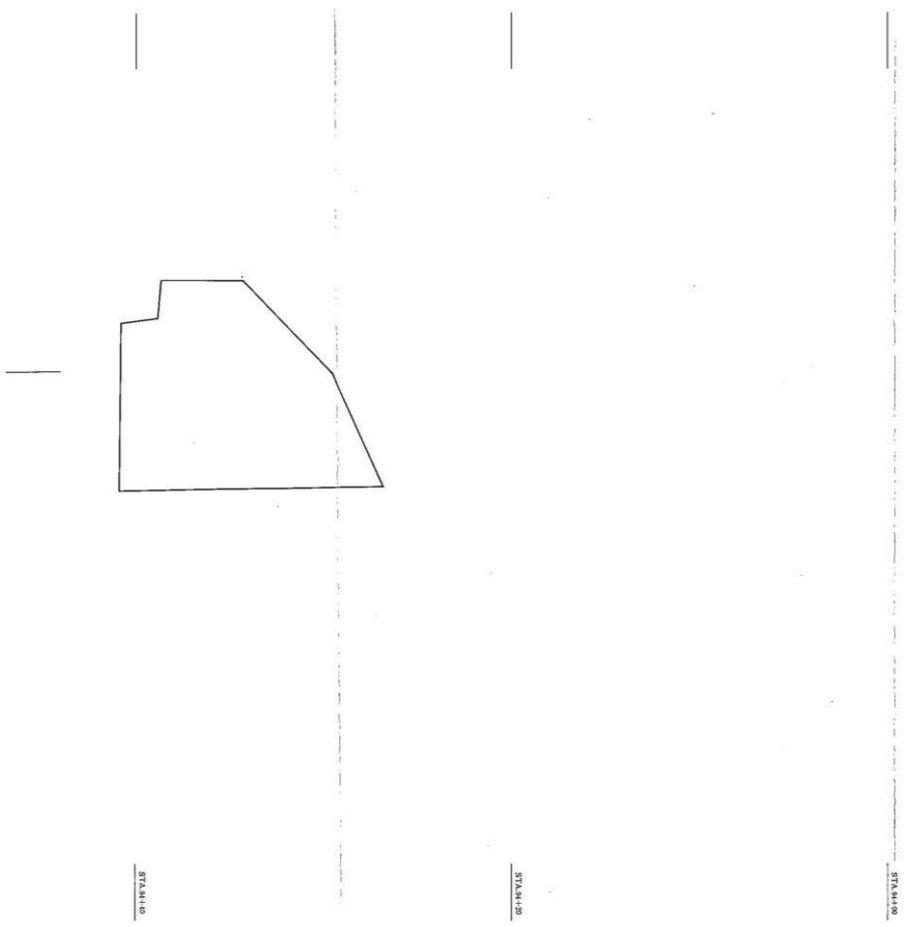
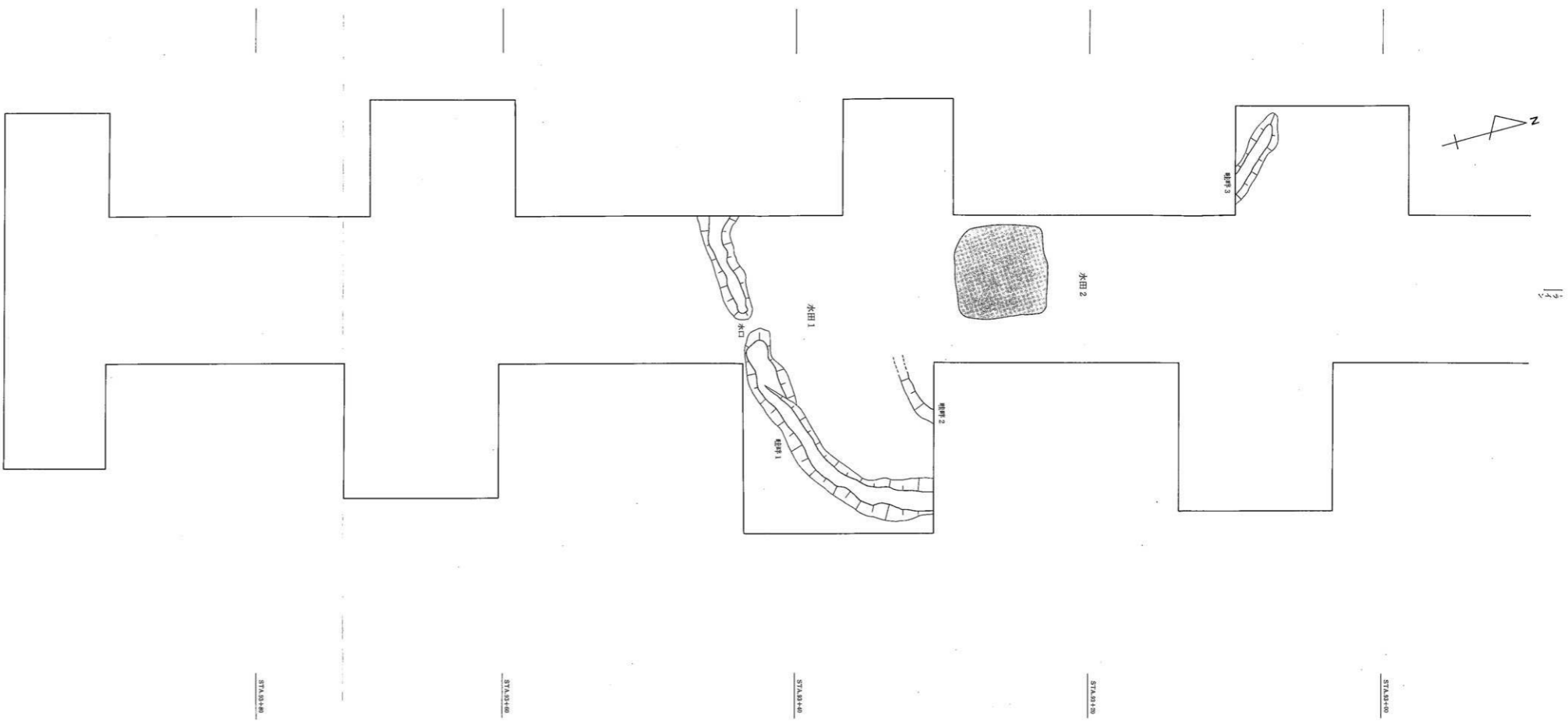

付図12 弥生時代後期 I 全体図② (5m)

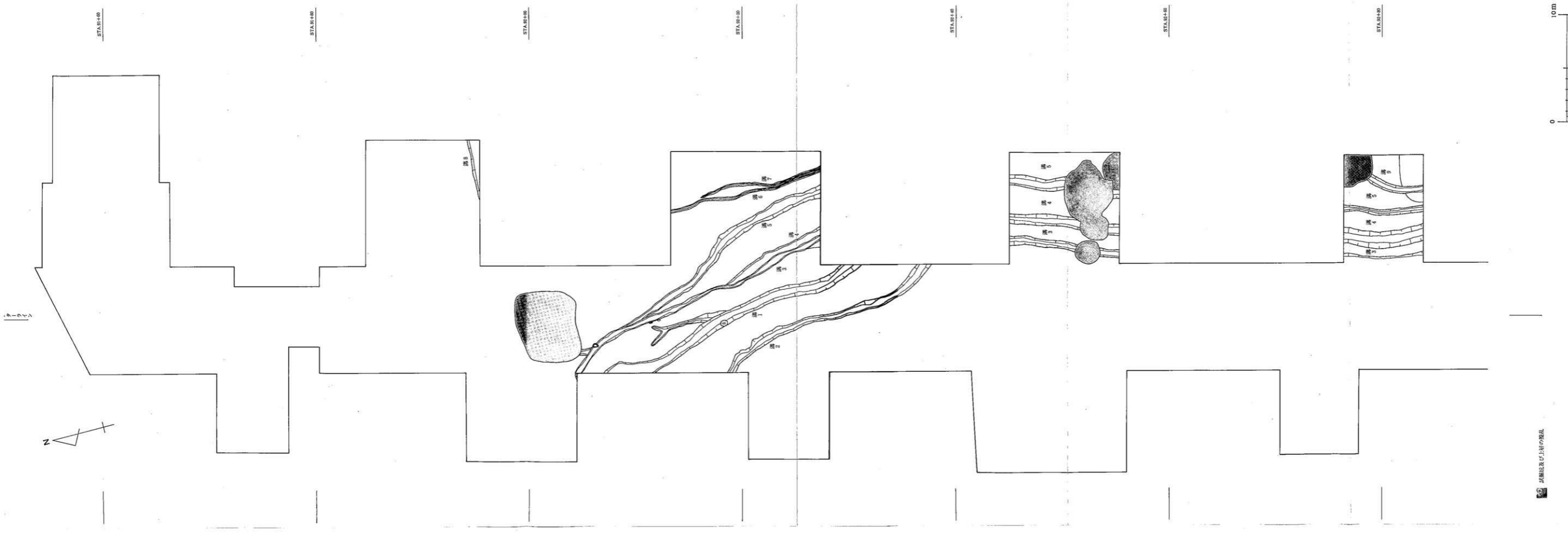

付図13 第三紀後期Ⅱ全体図① (5m)



图14 弥生时代后期II 全体图② (1/500)



付図15 古墳時代後期全体図① (1/500)

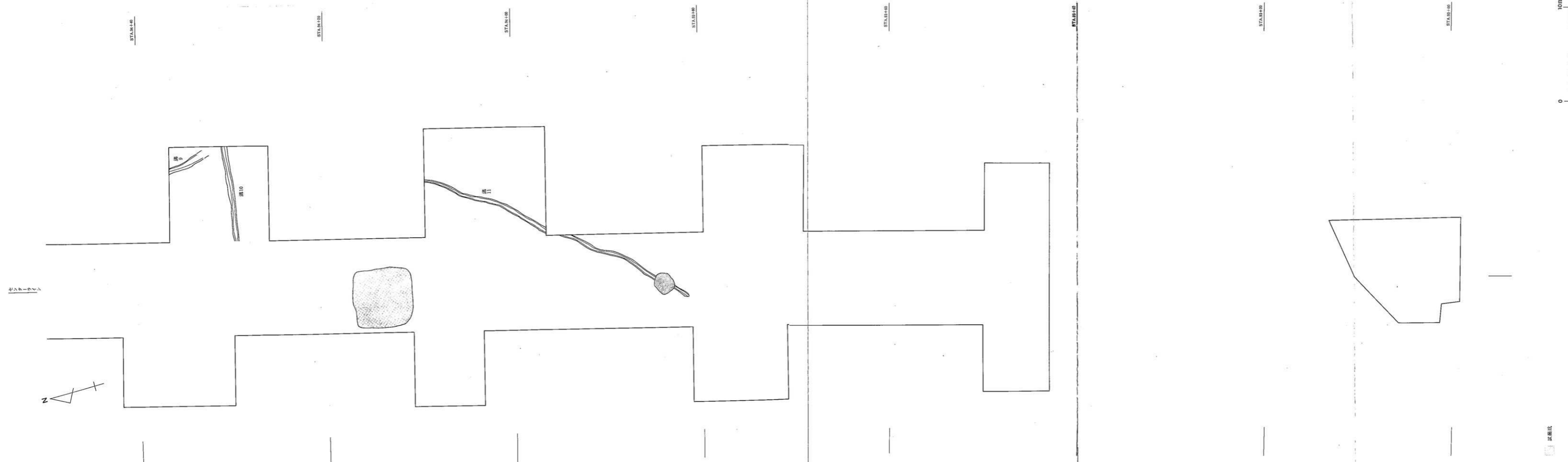
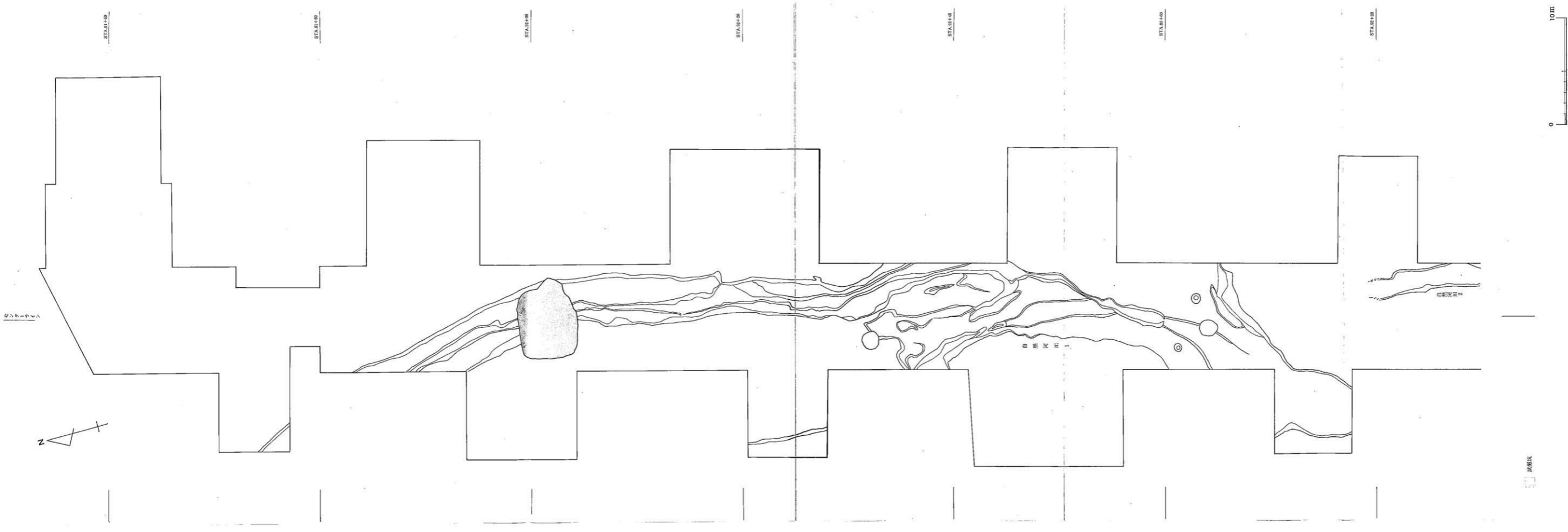
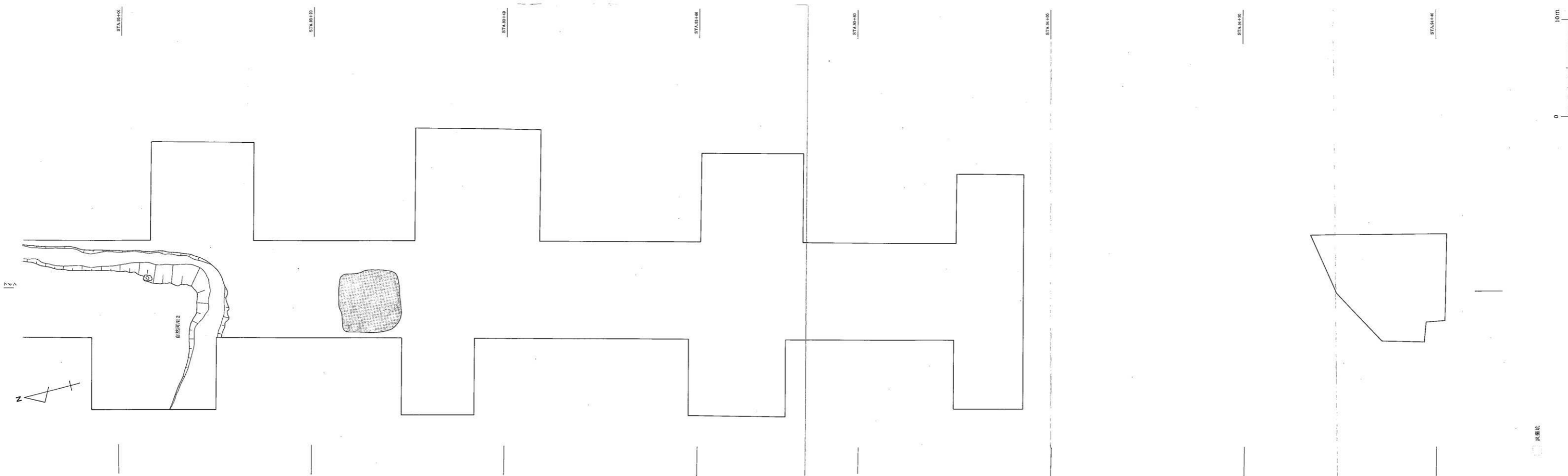

付圖16 古墳時代後期全体圖② (1/500)

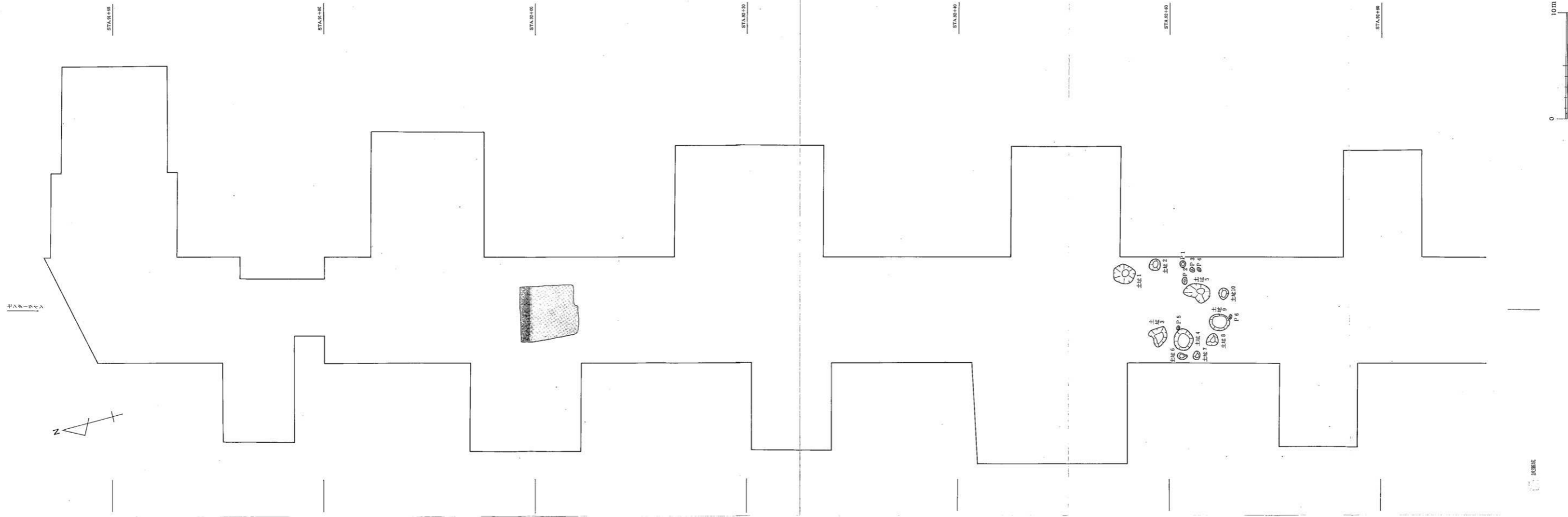

付图17 古代·中世全体图① (1/50)

4.5.8-0.5.5

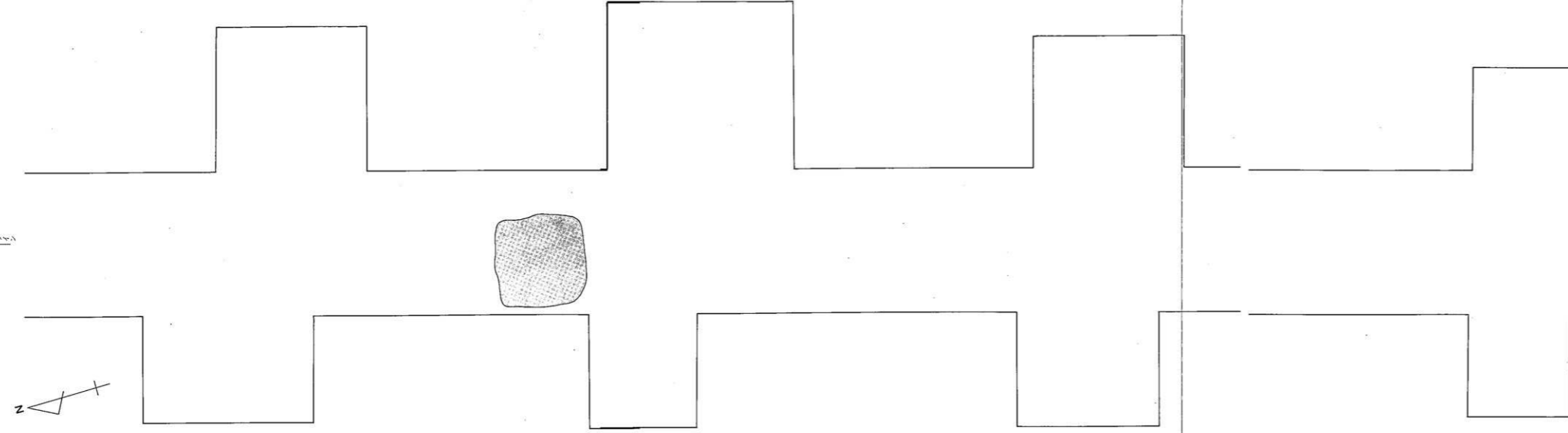

STA. 0+10

STA. 0+20

STA. 0+30

STA. 0+40

STA. 0+50

STA. 0+60

STA. 0+70

STA. 0+80



付图18 古代·中世全体图②(%)

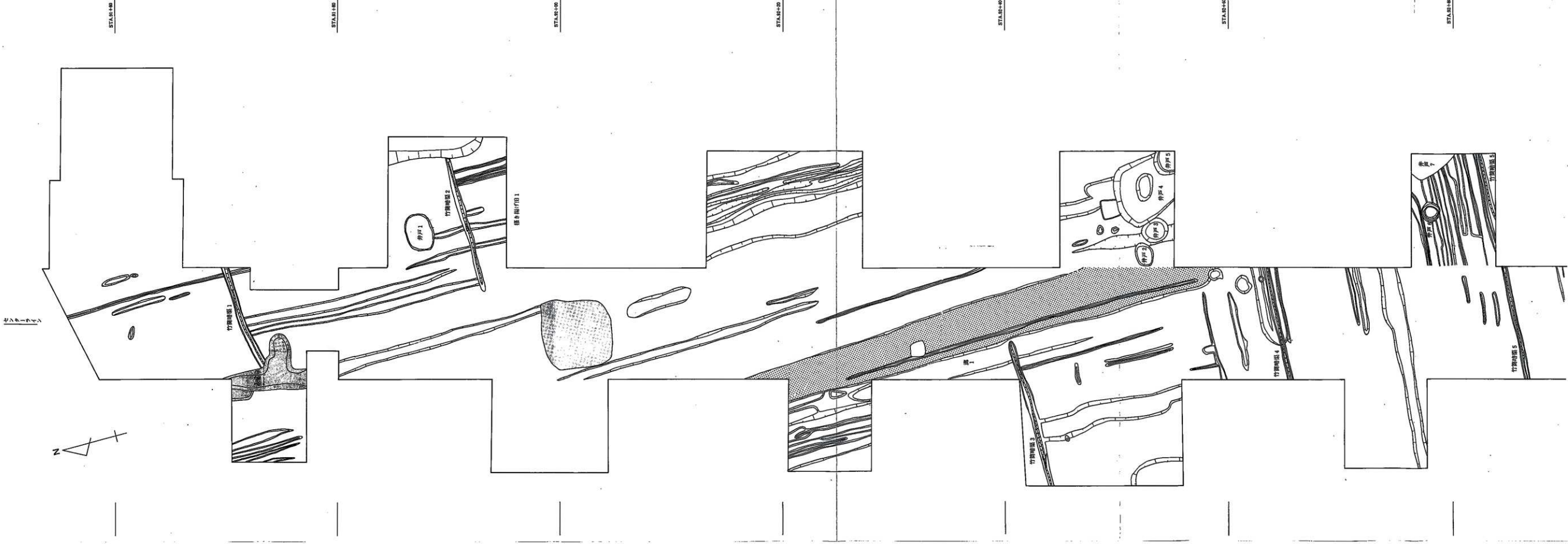

付図19 近世・近代全体図①(左)

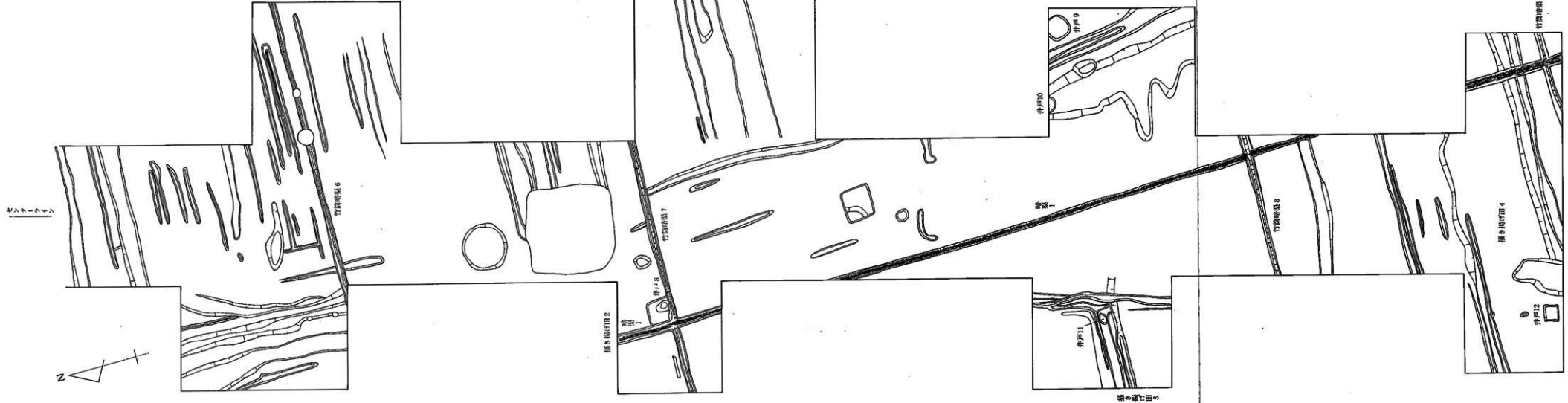

北



STALN-10

STALN-20

STALN-30

STALN-40

STALN-50

STALN-60

STALN-70

STALN-80

0 10m

試掘坑及び探坑

付图20 近世・近代全体图② (1/50)